

METINNO® 5000 Series

ALUMINIUM SLIDING DOOR SYSTEM

Detail 1 | Typical Floor Plan Showing Metinno 5000 Used in Office Construction

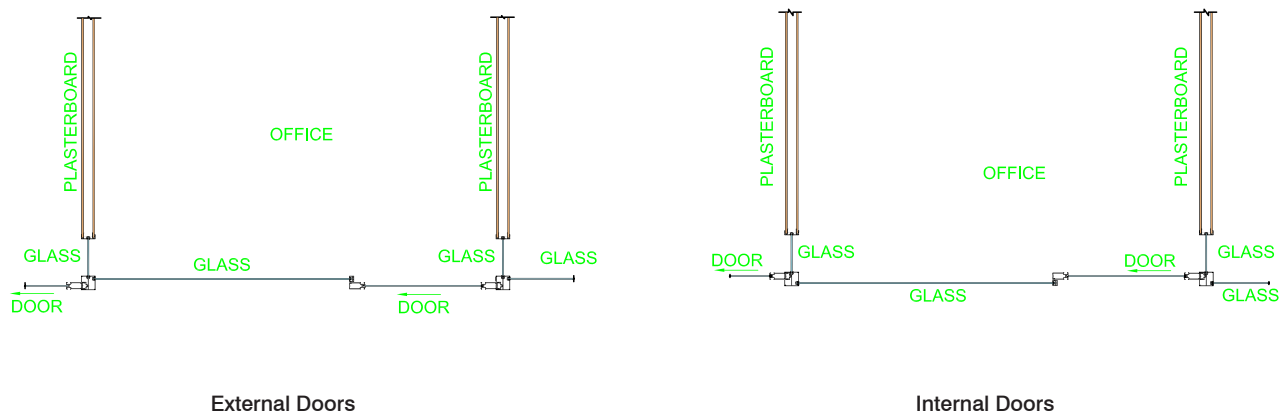

Detail 2 | Typical Elevation

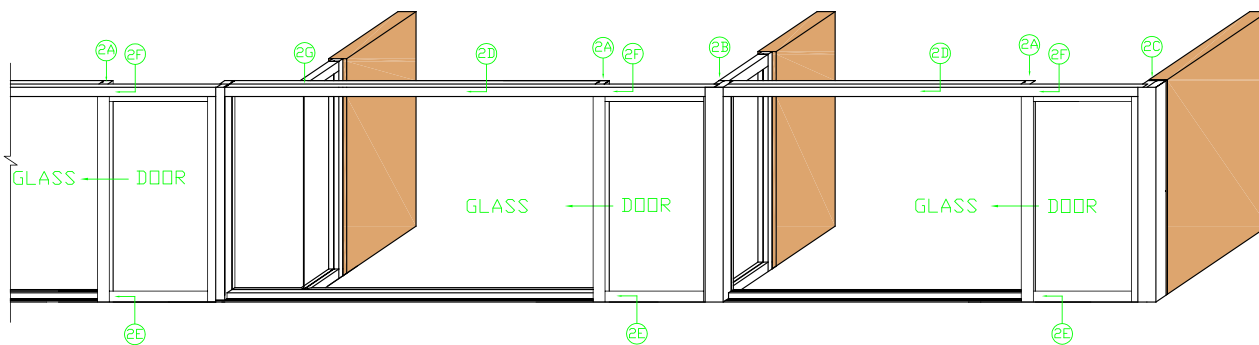

See following pages for drawings 2A to 2G

Colour Legends

- Aluminium Partition (face and section)
- Steel Stud
- Plasterboard Profile

Detail 2A | Horizontal Detail of Trailing Stile Showing Plain Stile

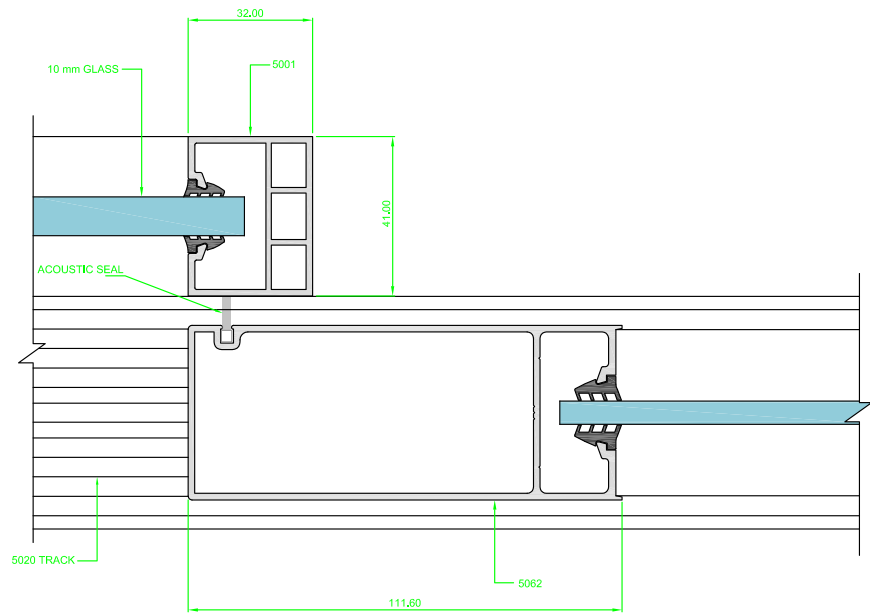

Trailing stile using 5062

METINNO® 5000 Series

ALUMINIUM SLIDING DOOR SYSTEM

Detail 2B | Horizontal Detail of Post Detail with Glazing Used for Sliding Doors

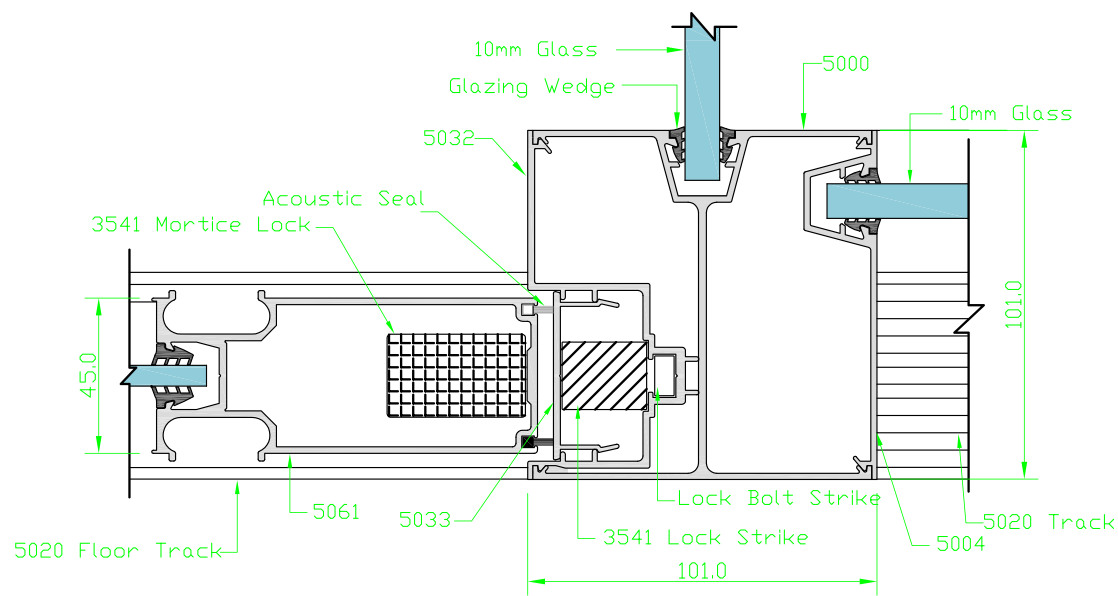

Sliding door externally

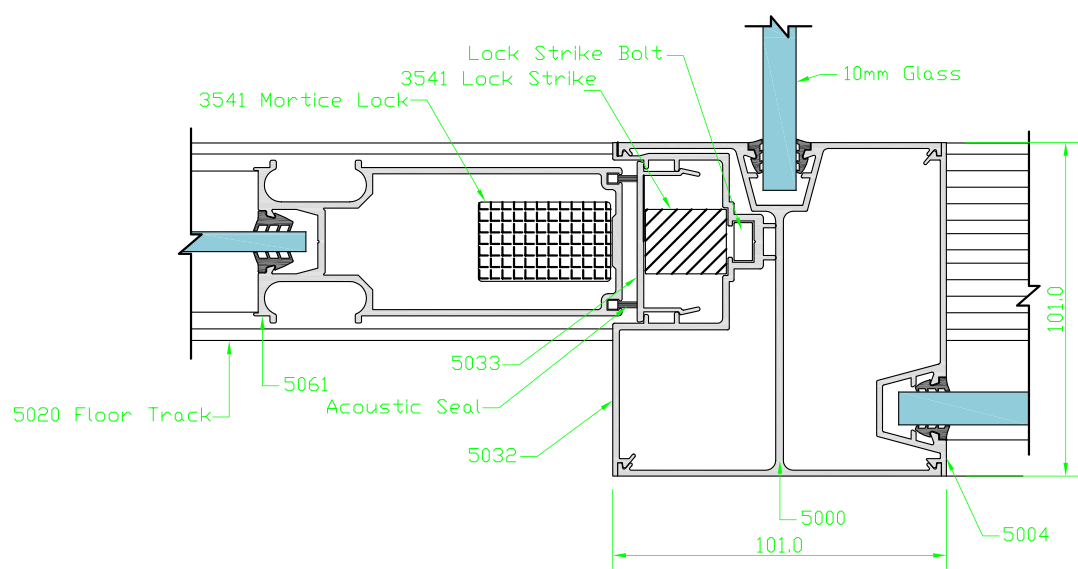

Sliding door internally

Colour Legends

- Aluminium Partition (face and section)
- Steel Stud
- Plasterboard Profile

SLIDING DOOR CONSTRUCTION DETAILS

Detail 2C | Horizontal Detail of Corner Post and Plasterboard Wall Intersection for Sliding Doors

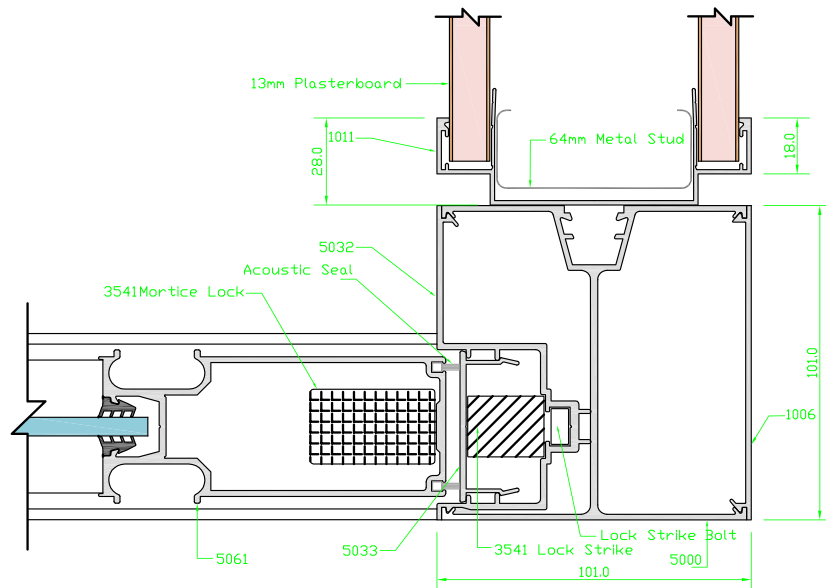

Sliding door externally

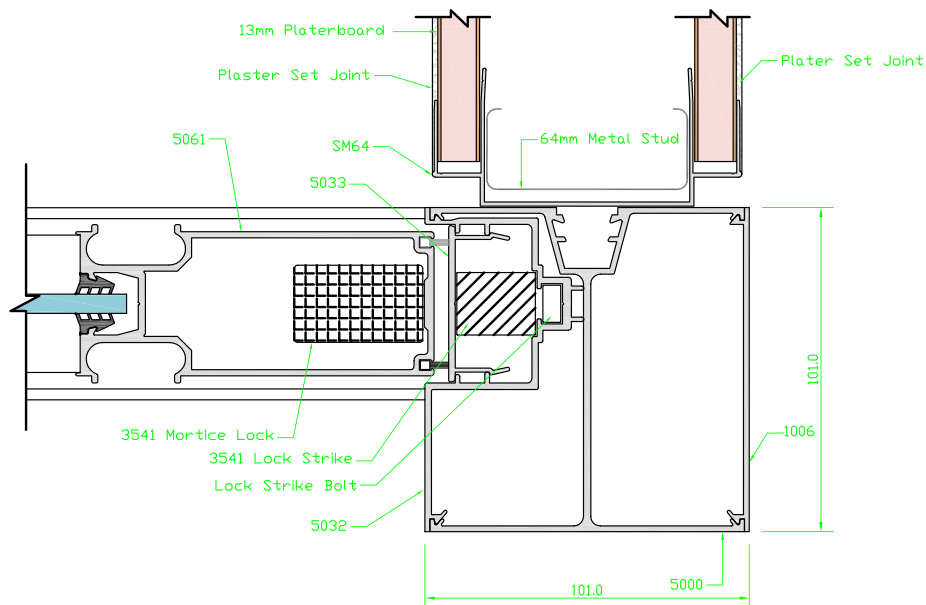

Sliding door internally

ALUMINIUM SLIDING DOOR SYSTEM

Technical cross-section diagram of a window assembly. The diagram shows a vertical window frame with a central glass pane. Key components and dimensions are labeled:

- Ceiling Line**: Indicated by a green arrow pointing to the top horizontal frame component.
- 5030**: Label for the top horizontal frame component.
- 41.0**: Dimension for the width of the top frame section.
- 5001**: Label for the upper part of the vertical frame.
- Glazing Wedge**: Label for the component securing the glass in the upper frame.
- 10mm Glass**: Label for the central glass pane.
- 5020B**: Label for the lower part of the vertical frame.
- 5020A**: Label for the bottom horizontal frame component.
- 5003**: Label for the lower part of the vertical frame.
- 5002**: Label for the bottom horizontal frame component.
- 32.0**: Dimension for the height of the lower frame section.
- 41.0**: Dimension for the width of the bottom frame section.
- Floor Line**: Indicated by a green arrow pointing to the bottom horizontal frame component.

6mm Glass

Glazing Wedge

5414

5412

107

5022
Stainless Steel Roller

5020A

5020B

10 mm Glass

5003

5002

Floor Line

08 8292 5000

SLIDING DOOR CONSTRUCTION DETAILS

Detail 2F | Vertical Detail of Sliding Door in Head Track

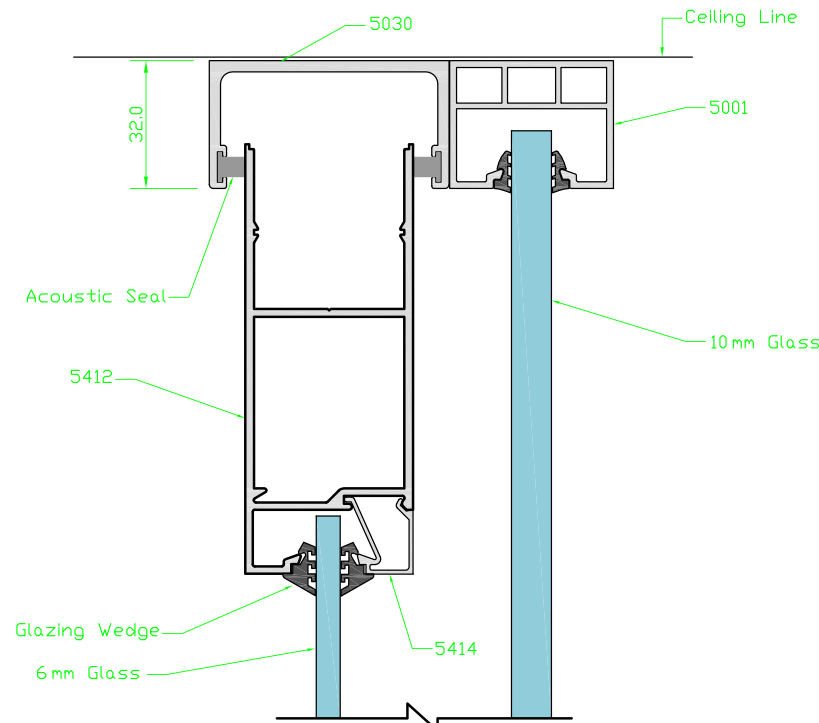

METINNO® 5000 Series

ALUMINIUM SLIDING DOOR SYSTEM

Detail 2G | Horizontal Detail of Section 5101 Used in Conjunction with Mitre Joints for Sliding Doors

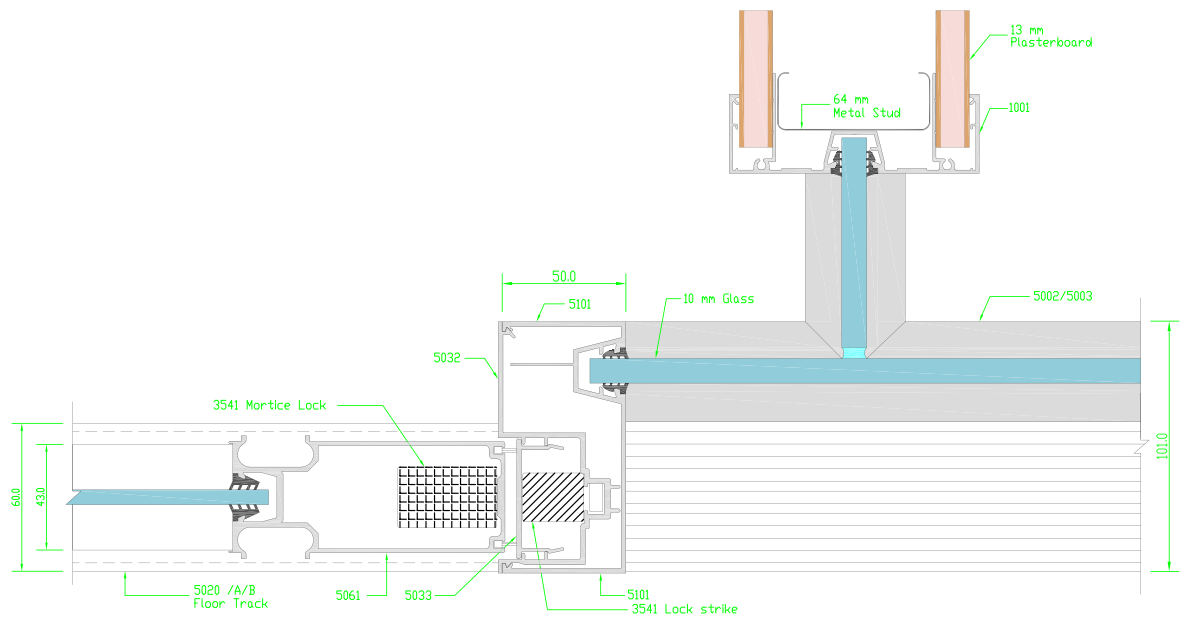

Sliding door externally

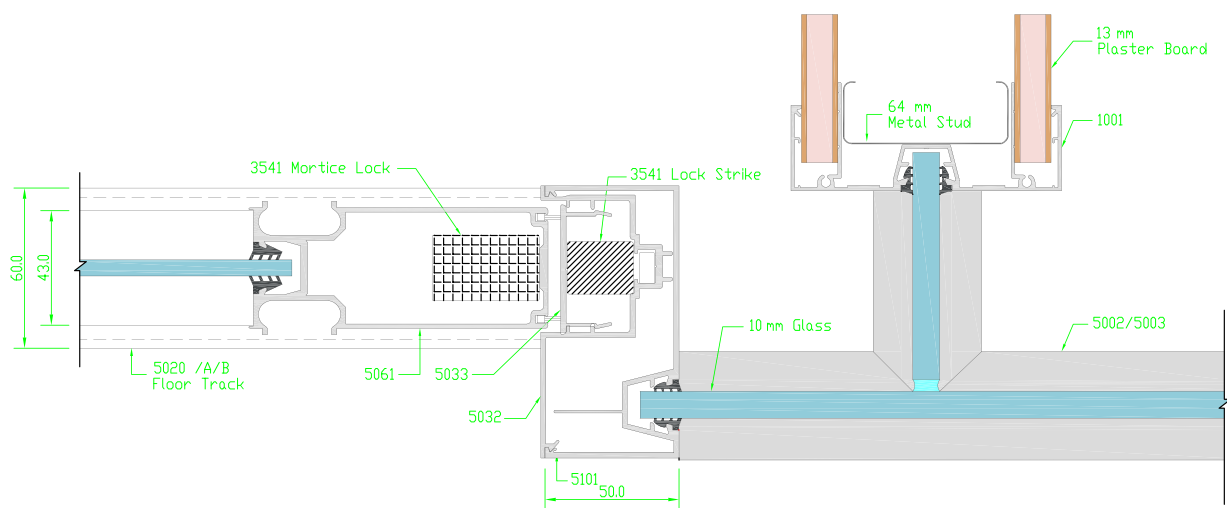

Sliding door internally

Colour Legends

- Aluminium Partition (face and section)
- Steel Stud
- Plasterboard Profile

SLIDING DOOR CONSTRUCTION DETAILS

Detail 3 | Internal Sliding Door Meeting Section 5101 Used in Conjunction with Corner Post

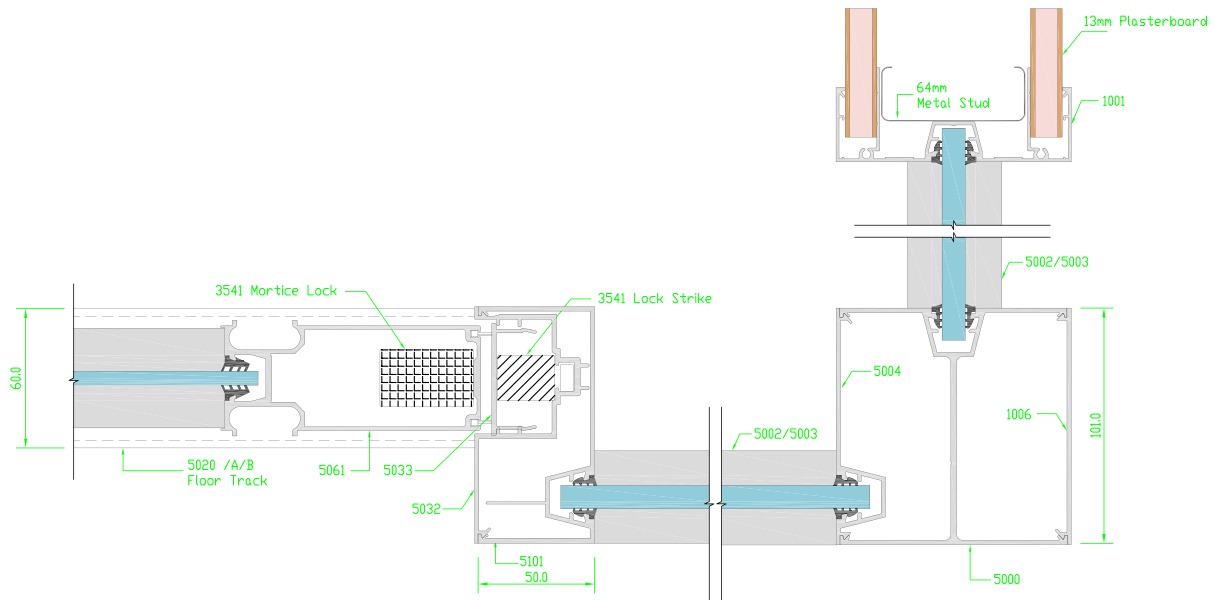

Detail 4 | Horizontal Detail for Multipanel Double Overlapping Slider for Wider Opening

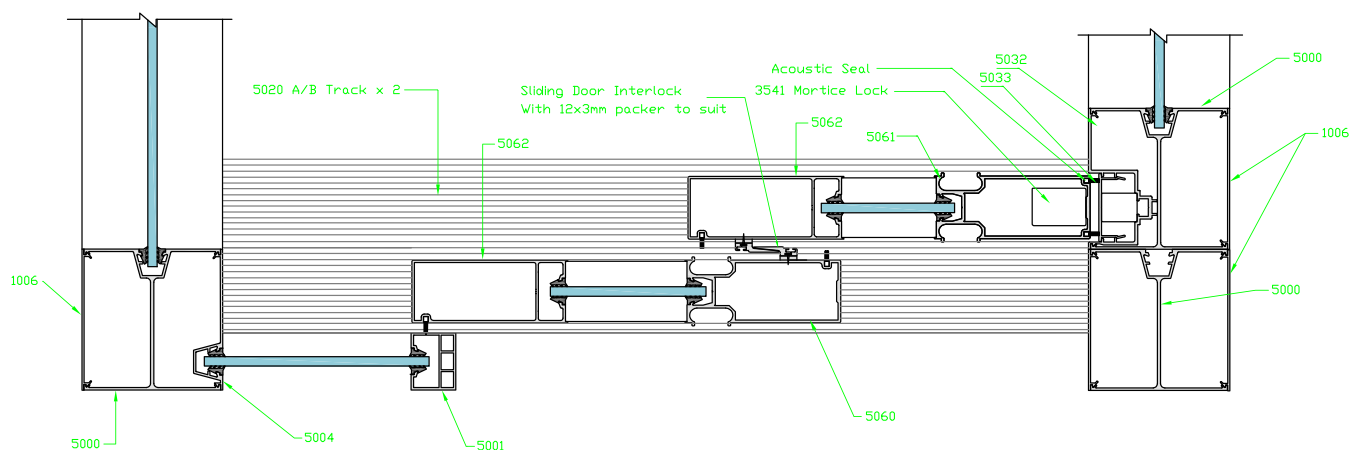

METINNO® 5000 Series

ALUMINIUM SLIDING DOOR SYSTEM

Detail 5 | Horizontal Detail for Multipanel Doors to Open Up Rooms

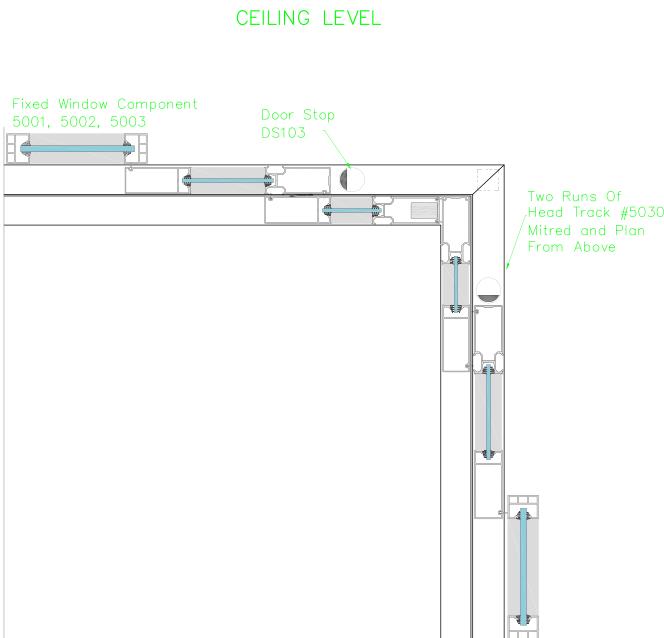
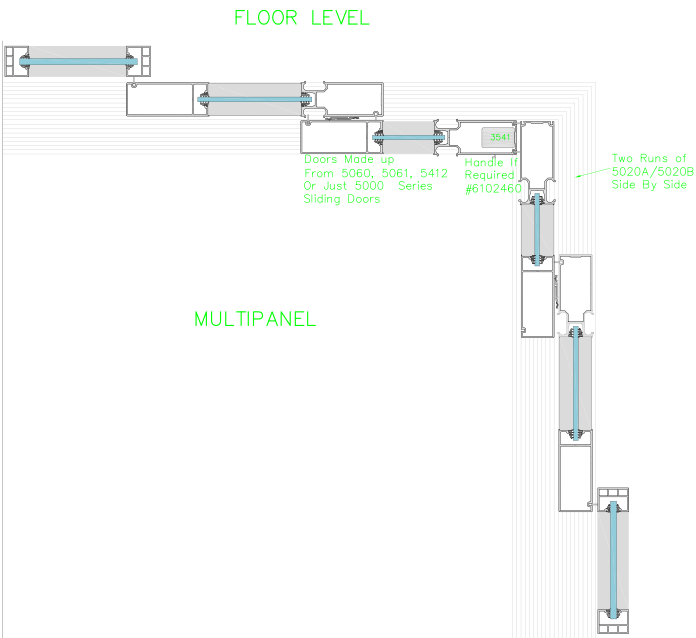

Colour Legends

- Aluminium Partition (face and section)
- Steel Stud
- Plasterboard Profile

SLIDING DOOR CONSTRUCTION DETAILS

Detail 6 | Detailed Drawing Of Door Rail 5412 Showing Unique Acoustic Seal 5413

Metinno's uniquely designed rail brings you a sliding door with acoustic seals on all four sides. Whether it is essential for an increased acoustic performance, or taking climate control to greater levels of achievement, this addition to the Metinno 5000 will literally close a gap that acoustic specialists and design consultants have been drawing attention to for many years.

With the acoustic seal in header track and both leading and trailing edge, a significant acoustic value is already achieved. The additional acoustic seal between the base of door and wheel arch of floor track effectively completes the system.

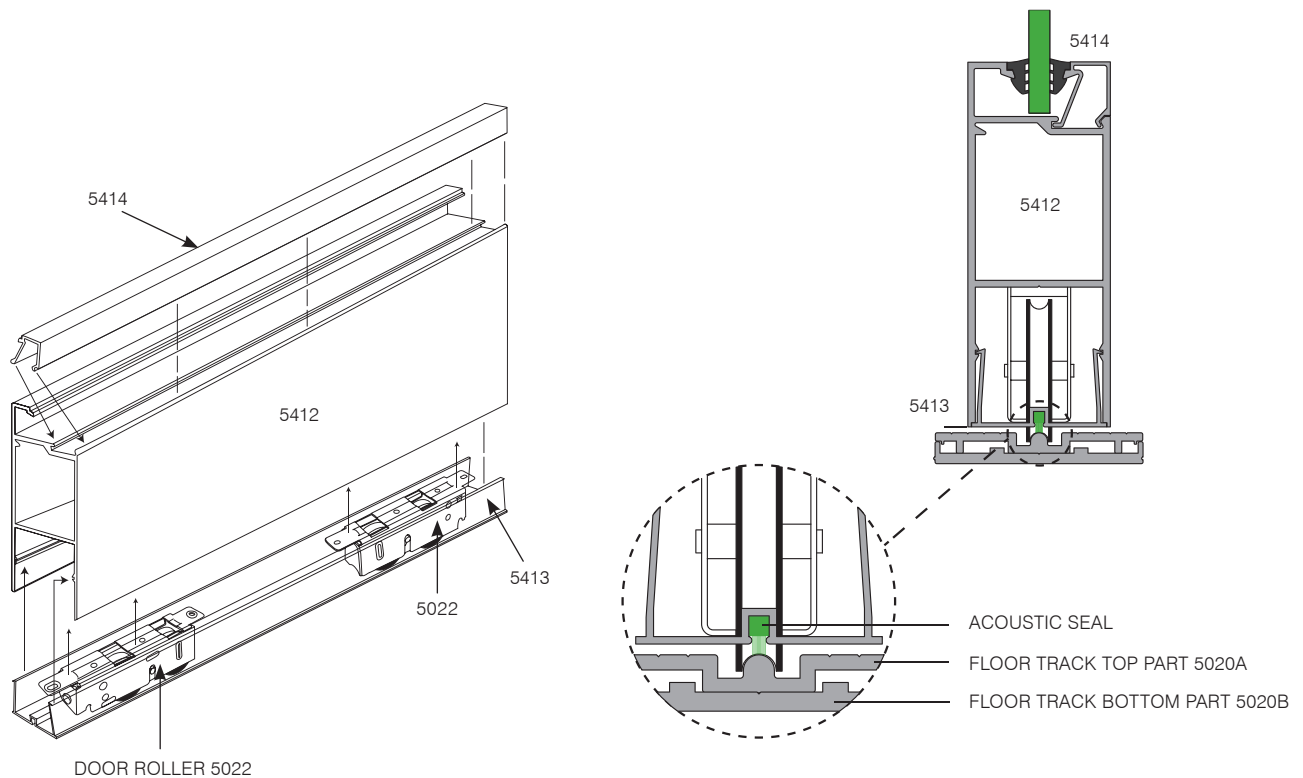

METINNO® 5000 Series

ALUMINIUM SLIDING DOOR SYSTEM

Detail 7 | Vertical Detail of 5000 Door and Main Frame

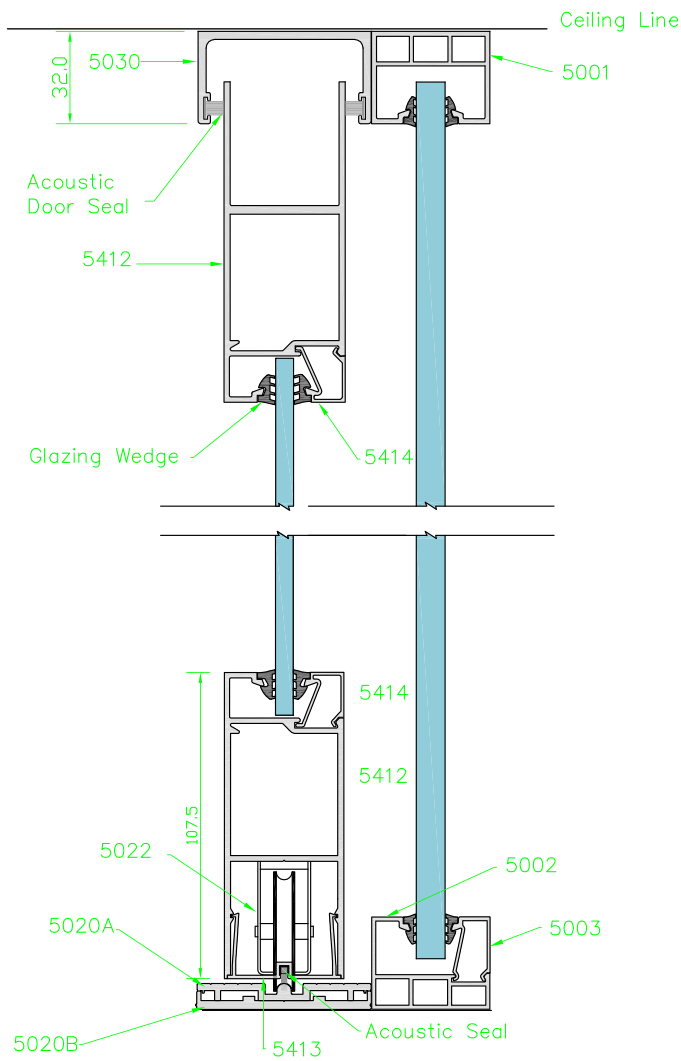

Colour Legends

- Aluminium Partition (face and section)
- Steel Stud
- Plasterboard Profile

SLIDING DOOR CONSTRUCTION DETAILS

Detail 8 | Horizontal Detail of 5000 Door and Main Frame

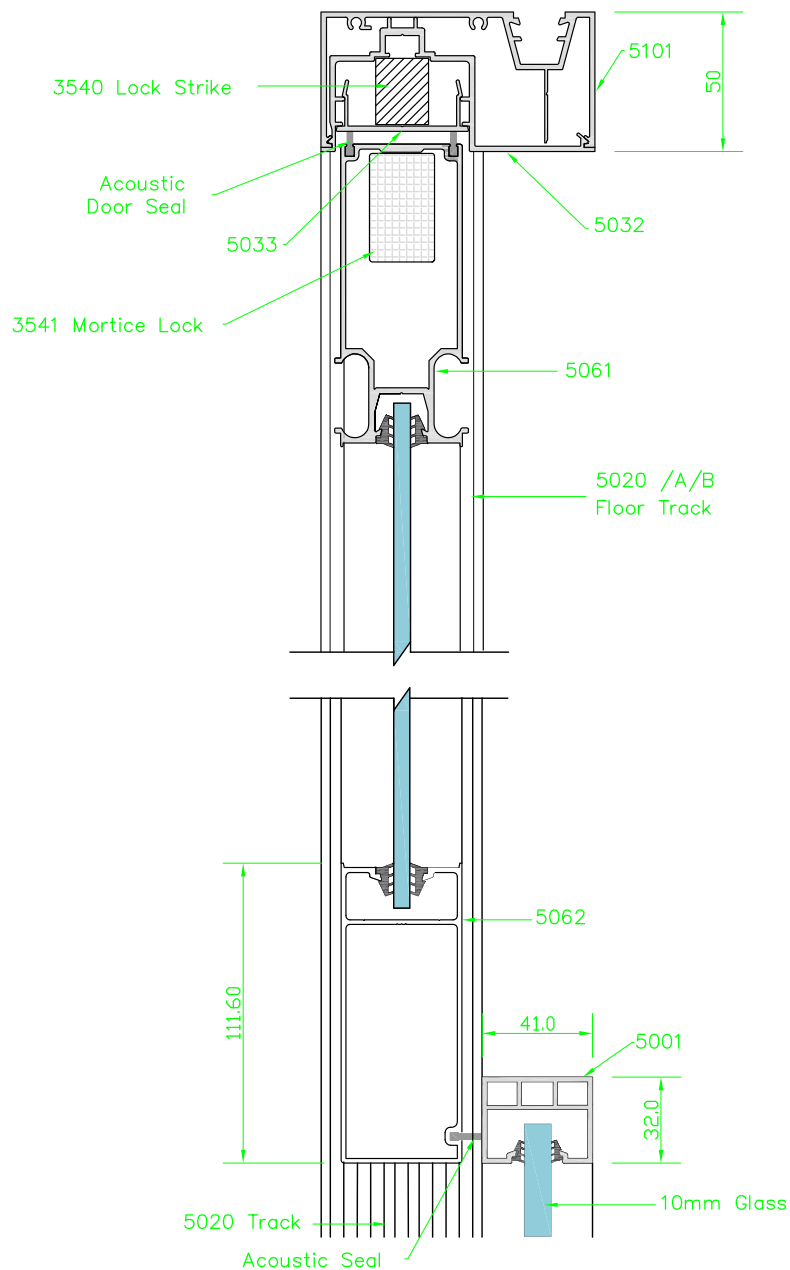

METINNO® 5000 Series

ALUMINIUM SLIDING DOOR SYSTEM

Detail 9 | Exploded View Sliding Door Integrated Handle

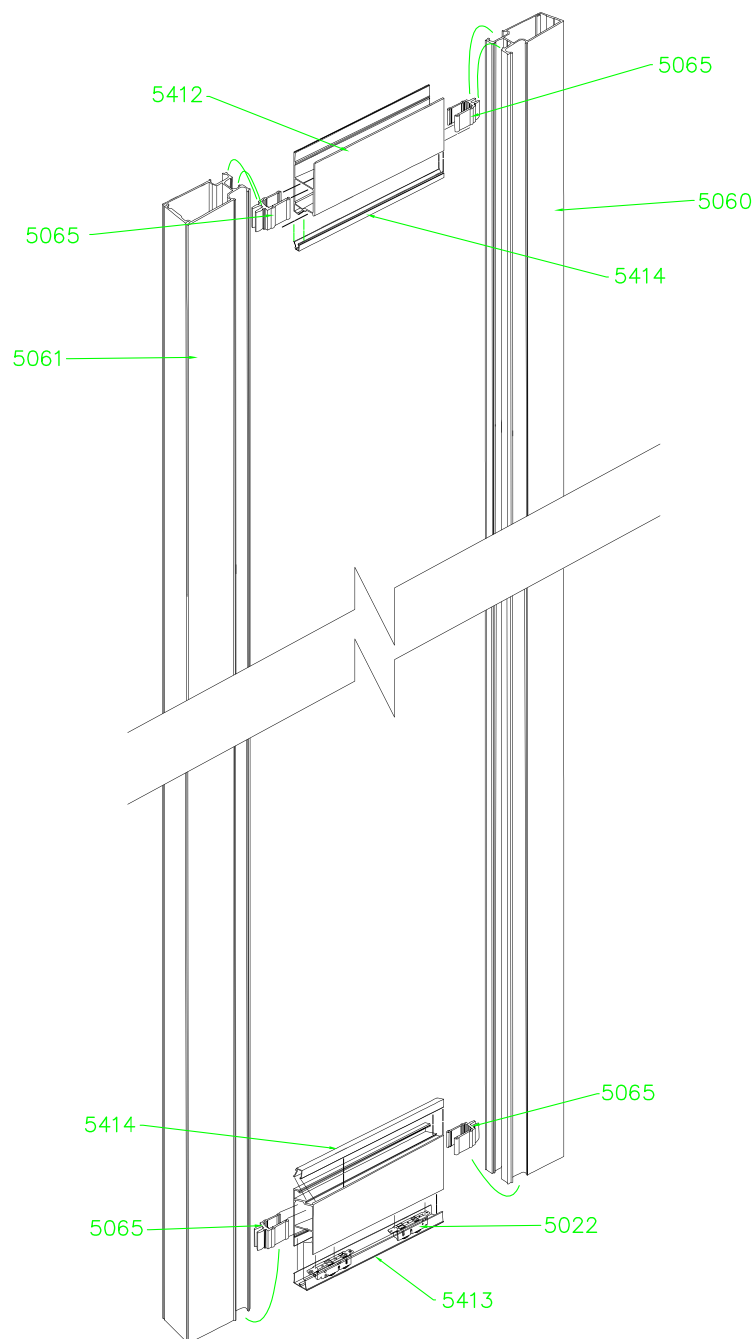

Colour Legends

- Aluminium Partition (face and section)
- Steel Stud
- Plasterboard Profile

Detail 10 | Exploded View Sliding Door Plain Stile

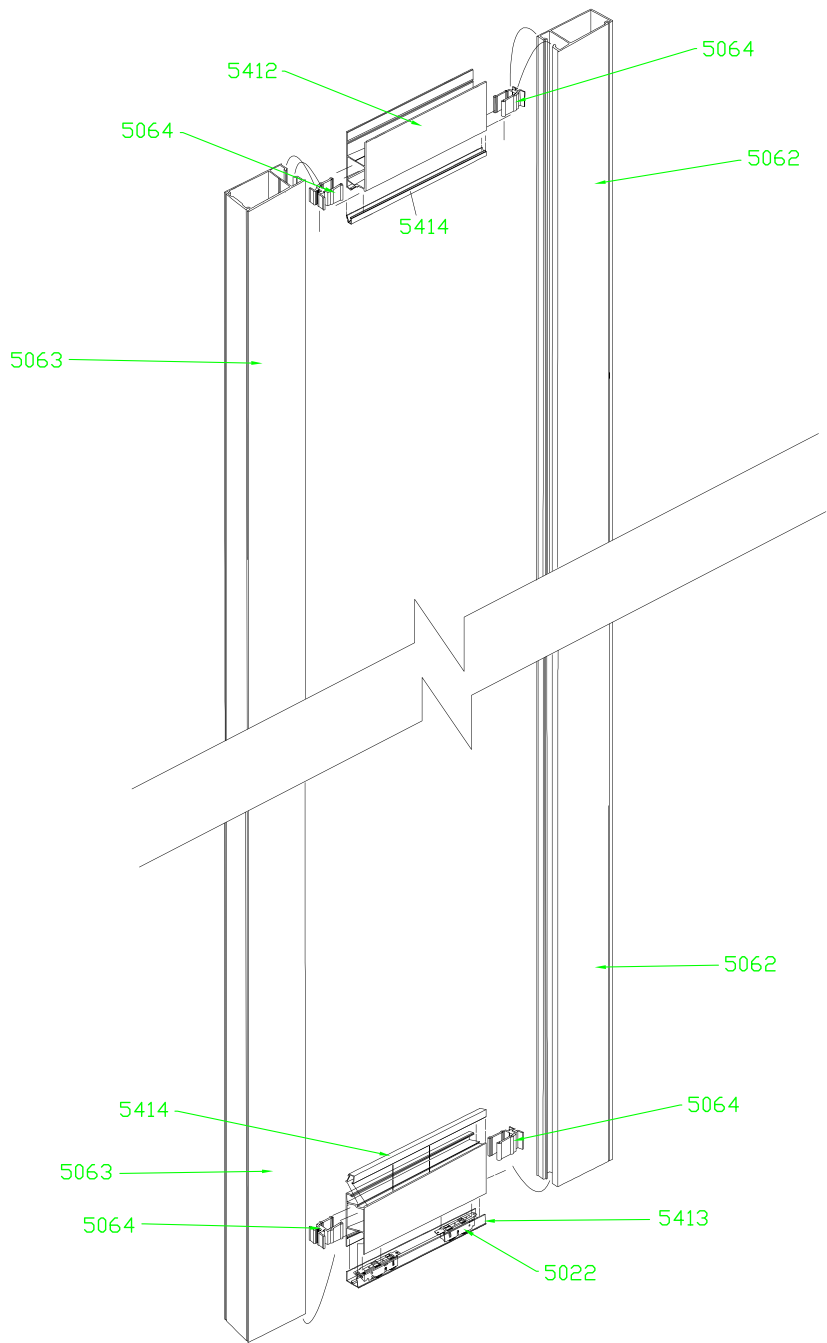

METINNO® 5000 Series

ALUMINIUM SLIDING DOOR SYSTEM

Detail 11A | Top Hung Vertical Detail of Heavy Duty Track, Pelmet & Roller

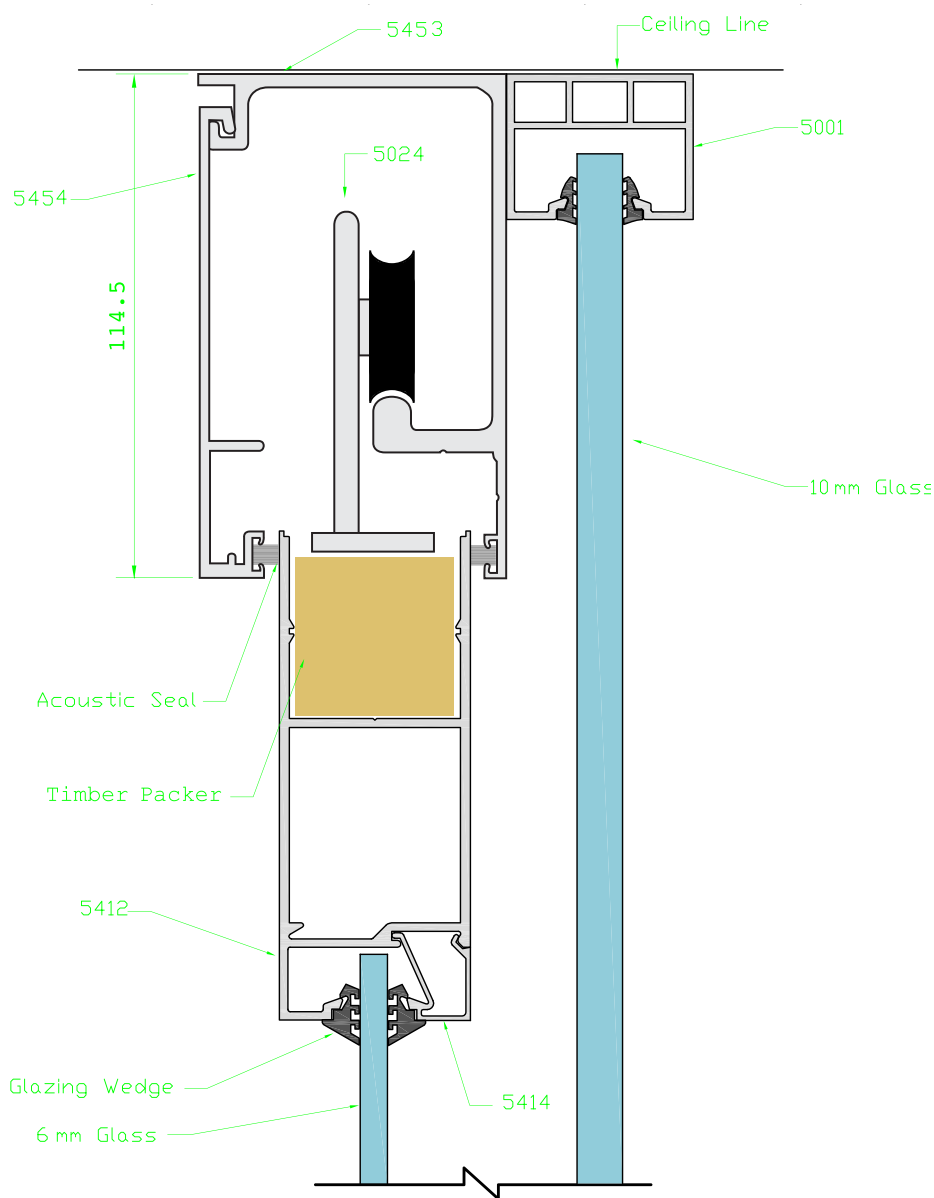

Colour Legends

- Aluminium Partition (face and section)
- Steel Stud
- Plasterboard Profile

SLIDING DOOR CONSTRUCTION DETAILS

Detail 11B | Top Hung Vertical Detail of Light Duty Track

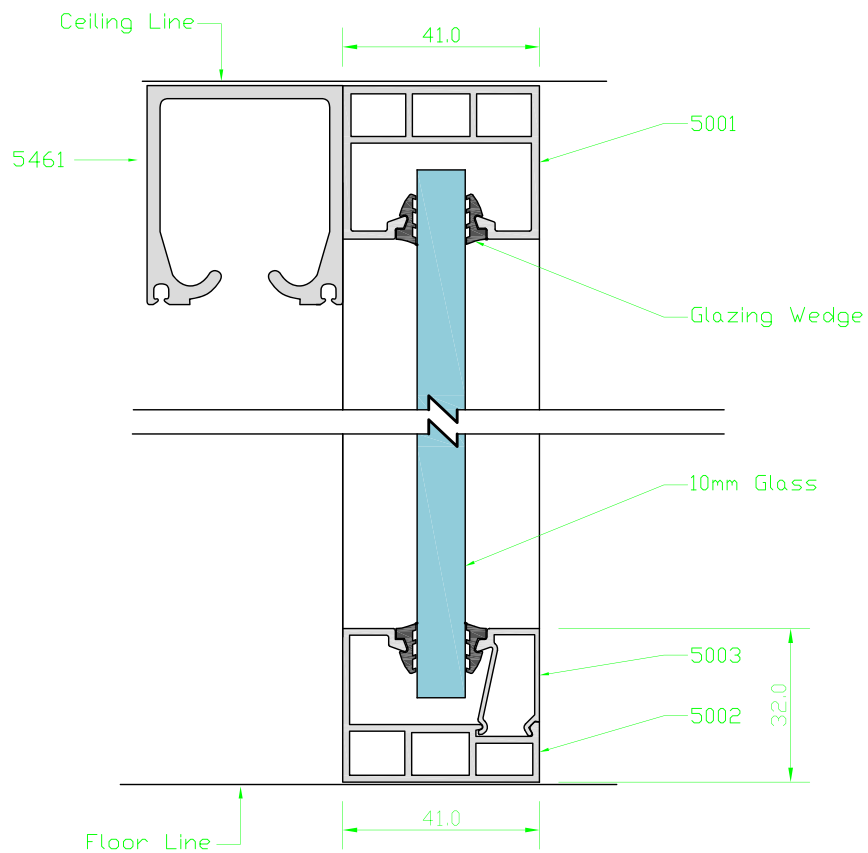

Detail 11C | Top Hung Horizontal Detail of Narrow Stile Side Seal

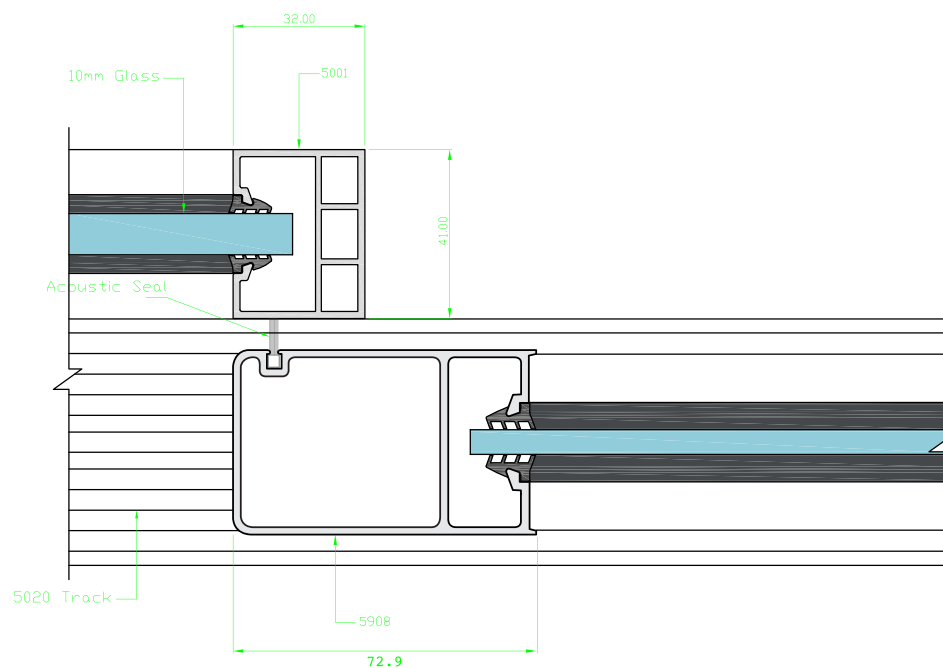

Glass
 Door
 Glazing Wedge Elevation View
 Glazing Wedge Profile
 Silicone Joint
 Timber Stud