

# Timber Doors Selection Guide

Internal and external timber doors suitable for a range of applications and specifications.



# Timber Doors Overview

Page	Door Type & Construction	Size	Internal	External	Primed	Acoustic Rating
3	<b>Hume Hollow Core</b> Hollow Core, Flush Panel	Standard & Custom	●	●	Redicote or Duracote	Up to RW12
	<b>Hume Solid Core</b> Solid Core, Flush Panel	Standard & Custom	●	●	Redicote or Duracote	Up to RW28
4	<b>Budget</b> MDF Frame, Raw MDF Skins	Custom	●		Raw	-
	<b>Prime</b> MDF Frame, Primed MDF Skins	Custom	●		Primed	-
5	<b>Standard</b> Hoop Pine Frame, Raw MDF Skins	Custom	●		Raw	-
	<b>Premium</b> Hoop Pine Frame, Primed MDF Skins	Custom	●		Primed	-
6	<b>RHS Support</b> For Budget & Prime - MDF Frame	Custom	●		Raw or Primed	-
	<b>RHS Support</b> For Standard & Premium - Hoop Pine Frame	Custom	●		Raw or Primed	-
7	<b>External</b> KDHW Framed, Particle Board Core	Custom	●	●	Raw or Primed	-
	<b>Lead Radiation Doors</b> Lead Lined, MDF Skins	Custom	●		Raw or Primed	-
8	<b>Acoustic Acoulite</b> Particle Board Frame, Acoustic Polyester/Polystyrene Core	Custom	●		Raw or Primed	RW29 - RW36
	<b>Acoustic Supatel</b> Budget & Prime - MDF Frame. Standard & Premium - Hoop Pine Frame. Acoustic Insulation Core.	Custom	●		Raw or Primed	RW30
9	<b>Metinno Sliding Doors</b> Semi-Solid MDF Flush Panel, Pinetop with Groove	Custom	●		Raw or Primed	-
	<b>Metinno RHS Sliding Doors</b> Semi-Solid MDF Flush Panel, Pinetop with Groove & RHS Support	Custom	●		Raw or Primed	-
10	<b>Fire Rated Doors</b> Monolithic Refractory Core	Custom	●	●		-
11	<b>Extras:</b> Finishes, Handing, Viewing Panels					
12	<b>Door Care:</b> Bowed Doors & Door Treatment On-site					



Flush Panel

# Hume Hollow Core Redicote

The Hume Hollow Core Timber Door is constructed from a high density honeycomb core which provides an acoustic rating up to RW12. Most commonly used for internal purposes, it can also be used externally with a Duracote Primed face\*. Suitable for a range of residential and commercial projects such as offices and schools.

\*Duracote available to order in.

Construction Drawings

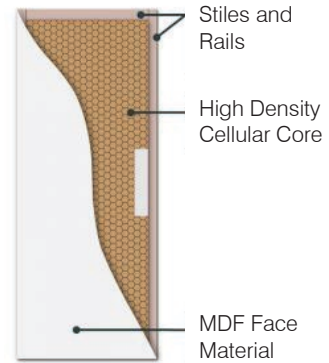
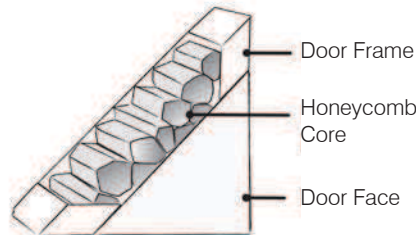

Code	Description	Size	Acoustic Rating
35HC	Hume Hollow Core, Flush Panel	35 x 2040 x 720/770/820/870/920/970 35 x 2340 x 720/770/820/870/920/970 Custom size & thickness available.	Up to RW12



Flush Panel

# Hume Solid Core Duracote

The Hume Solid Core Timber Door has a high reputation for its solid construction and versatility. Suitable for internal and external purposes\*, it can achieve an acoustic rating of RW28 if used with the correct seals. Suitable for a range of residential and commercial projects such as offices, shop fitouts, schools and gymnasiums.

\*Redicote (for internal use) available to order in.

If being used externally Duracote Primed face is required.

Construction Drawings

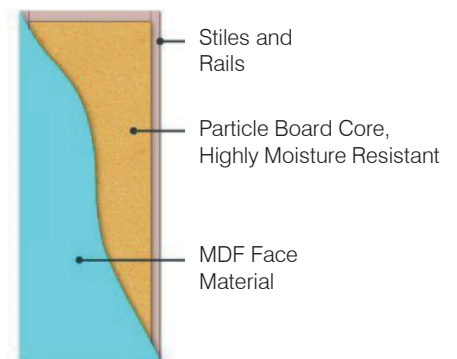
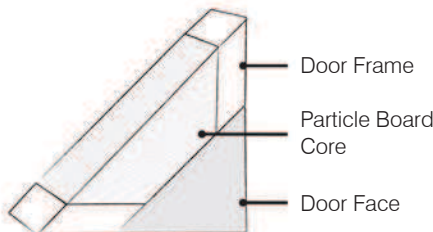

Code	Description	Size	Acoustic Rating
35SC	Hume Solid Core, Flush Panel	35 x 2040 x 720/770/820/870/920/970 35 x 2340 x 720/770/820/870/920/970 Custom size & thickness available.	Up to RW28



Flush Panel

**Budget** MDF Frame, Raw MDF Skins

The Budget range of timber doors are constructed with MDF Frame and Raw MDF Skins, for Hollow Core, Semi-Solid, Foam Core and Solid Core (MDF) options. Budget doors are suitable for internal use only.

Construction Drawings

MDF Hollow Core Foam Core

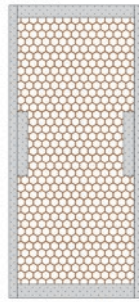

Hollow Core

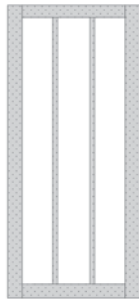

Semi-Solid



Foam Core



Solid Core (MDF)

Description

Budget Timber Door - MDF Frame Raw MDF Skins

Size

Any custom sizes are available up to (H)3000 x (W)1800mm



Flush Panel

**Prime** MDF Frame, Primed MDF Skins

The Prime range of timber doors are constructed with MDF Frame and Primed MDF Skins, for Hollow Core, Semi-Solid, Foam Core and Solid Core (MDF) options. Prime doors are suitable for projects where doors may not be painted for some time and require the added protection of the primed skins.

Construction Drawings

MDF Hollow Core Foam Core

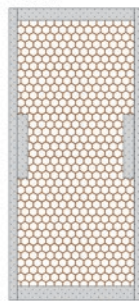

Hollow Core

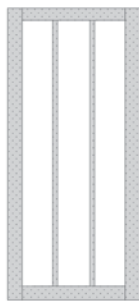

Semi-Solid



Foam Core



Solid Core (MDF)

Description

Prime Timber Door - MDF Framed Primed MDF Skins

Size

Any custom sizes are available up to (H)3000 x (W)1800mm



Flush Panel

# Standard Hoop Pine Frame, Raw MDF Skins

The Standard range of timber doors are constructed with Hoop Pine Internal Frame and Raw MDF Skins, for Hollow Core, Semi-Solid, Foam Core, Solid Core (MDF) and Solid Core (Particle Board) options. Standard doors are supplied with Pine on all edges to ensure all hinges, trolleys and other hardware are screwed into timber - not just MDF.

Construction Drawings

MDF    Hollow Core    Foam Core    Hoop Pine    Particle Board

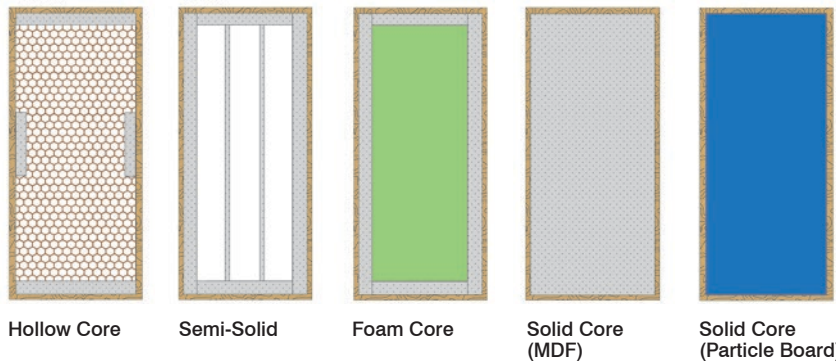

Description

Size

Standard Timber Door - Pine Frame Raw MDF Skins

Any custom sizes are available up to (H)3000 x (W)1800mm



Flush Panel

# Premium Hoop Pine Frame, Primed MDF Skins

The Premium range of timber doors are constructed with Hoop Pine Internal Frame and Primed MDF Skins, for Hollow Core, Semi-Solid, Foam Core, Solid Core (MDF) and Solid Core (Particle Board) options. Premium doors are supplied with Pine on all edges to ensure all hinges, trolleys and other hardware are screwed into timber - not just MDF. The primed skins give a leading edge to the quality of painted finish and also saves time on site.

Construction Drawings

MDF    Hollow Core    Foam Core    Hoop Pine    Particle Board

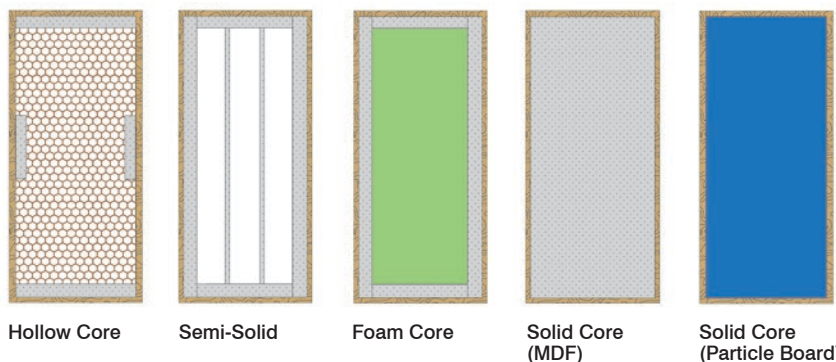

Description

Size

Premium Timber Door - Pine Frame Primed MDF Skins

Any custom sizes are available up to (H)3000 x (W)1800mm

**What is RHS?** Steel "Rectangular Hollow Section" for vertical strength & prevention of door bowing.



## Flush Panel RHS Support For Budget & Prime

The Budget and Prime range of RHS timber doors are constructed with MDF Frame with RHS vertical supports, for Semi-Solid, Foam Core and Solid Core (MDF) options. RHS Support doors are suitable for large doors that need extra strength and to prevent bowing.

*For RHS Sliding Doors suitable for cavity units see page 9.*

**Construction Drawings**  MDF  Foam Core  RHS Support

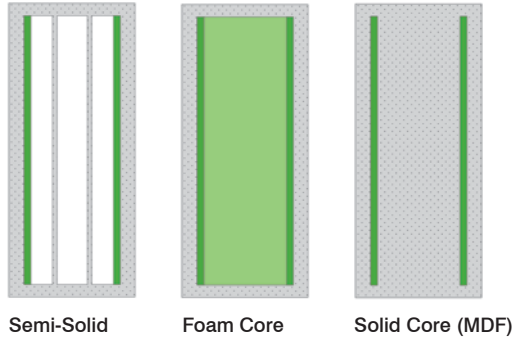





Description	Size
RHS Timber Door - Budget & Prime	Any custom sizes are available up to (H)3000 x (W)1800mm



## Flush Panel RHS Support For Standard & Premium

The Standard and Premium range of RHS timber doors are constructed with Hoop Pine Internal Frame with RHS vertical supports, for Semi-Solid, Foam Core, Solid Core (MDF) and Solid Core (Particle Board) options. RHS Support doors are suitable for large doors that need extra strength and to prevent bowing.

*For RHS Sliding Doors suitable for cavity units see page 9.*

**Construction Drawings**  MDF  Hoop Pine  Foam Core  RHS Support  Particle Board

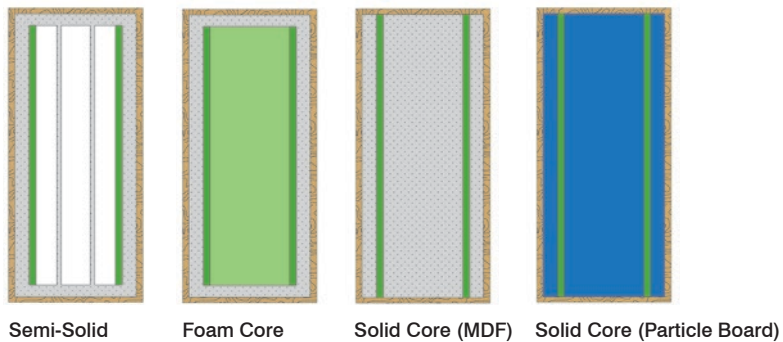

Description	Size
RHS Timber Door - Standard & Premium	Any custom sizes are available up to (H)3000 x (W)1800mm



Flush Panel

# External KDHW Framed, Particle Board Core

The External range of timber doors are constructed with KDHW (Kiln Dried Hard Wood) and Particle Board Core, for Prime, Standard and RHS Support options. KDHW frame provides a better screw-holding in the hinges and is a more resilient timber, making it highly suitable for external applications.

Construction Drawings

■ KDHW ■ Particle Board ■ RHS Support



Prime (Primed HMR\* Skins)

Standard (Raw Ply Skins)

Metal Clad

RHS Support

\*High Moisture Resistant

Description

Size

External Timber Door - KDHW Framed

Any custom sizes are available up to (H)3000 x (W)1800mm



Flush Panel

# Lead Radiation Doors

Lead Radiation Doors are suitable for X-Ray exposed areas as they are internally lined with lead which is a barrier to radiation. Lead lined doors are available for all levels of radiation. Additional layers can be added for increased performance.

Construction Drawing

Showing both sides lead lined.

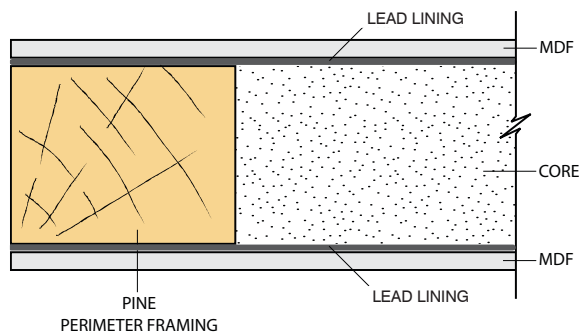

Description

Size

Medical Grade Timber Door - Lead Lined

Any custom sizes are available up to (H)3000 x (W)1800mm



## Flush Panel Acoulite Acoustic Composite Core, Laminated

This range was developed in consultation with the market to deliver a product which is lightweight, flexible in size and finishes, and offers an outstanding acoustic barrier between work areas. Each Acoulite Acoustic door is constructed with care from a composite core which includes hi-tech acoustic insulating mediums. The door can also be laminated with selected veneer skins to suit your project requirements.

### Construction Drawing

- Particle Board
- 25mm Polyester/Polystyrene

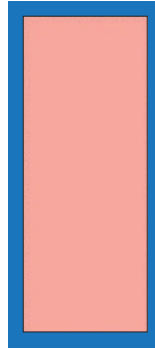

Description	Size	Acoustic Rating
Acoulite Acoustic Timber Door	Any custom sizes are available up to (H)3000 x (W)1800mm	RW29 - RW36



## Flush Panel Supatel Acoustic

The Supatel range is designed for instances where the acoustic value of a solid core door is required but reduction of the weight of the door is critical. Supatel lightens the door but provides better acoustic rating than a solid core equivalent.

### Construction Drawings

- MDF
- Hoop Pine
- Acoustic Insulation

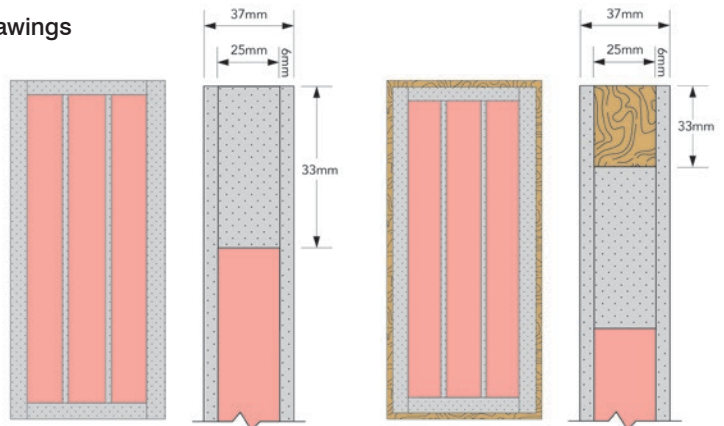

Description	Size	Acoustic Rating
Supatel Acoustic Timber Door	Any custom sizes are available up to (H)3000 x (W)1800mm	RW30





## Flush Panel Sliding Door

### Semi-Solid, Primed MDF, Pinetop

**METINNO®**

The Metinno Timber Sliding Doors are designed to pair with Metinno Cavity Slider Units. They have a timber section inserted in the top of the door where hardware fixings are required as well as a recessed groove on the bottom edge to suit "T" guide in base of Cavity Unit, saving you time on installation.

#### Construction Drawing

MDF
  Hoop Pine

Construction is semi-solid to reduce weight but solid-core is available on request.

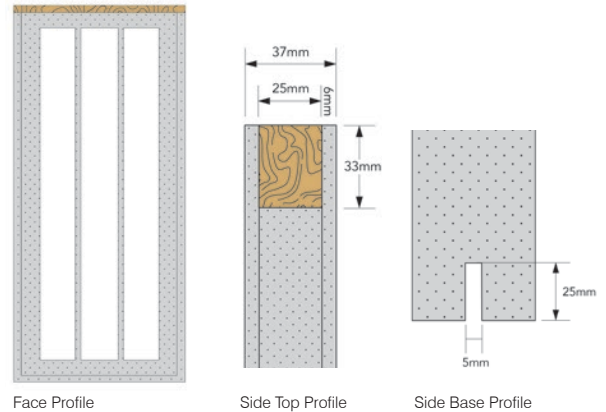

Code	Description	Sizes (mm)
MCXDFP	Metinno Door Semi-Solid MDF Flush Panel Pinetop With Groove	37 x 2040 x 720/820/920
		37 x 2340 x 720/820/920
		Custom sizes available - lead time applies



## Flush Panel RHS Sliding Door

### Semi-Solid, Primed MDF, Pinetop with RHS Support

**METINNO®**

The Metinno Timber Sliding Doors with RHS (Rectangular Hollow Steel) Supports are larger sized doors that are reinforced and prevent bowing. Designed to pair with Metinno Cavity Slider Units they have a timber section inserted in the top of the door where hardware fixings are required as well as a recessed groove on bottom edge to suit "T" guide in base of Cavity Unit, saving you time on installation. This door is pre-primed for moisture protection on-site pre lock up.

#### Construction Drawing

MDF
  Hoop Pine
  RHS Support

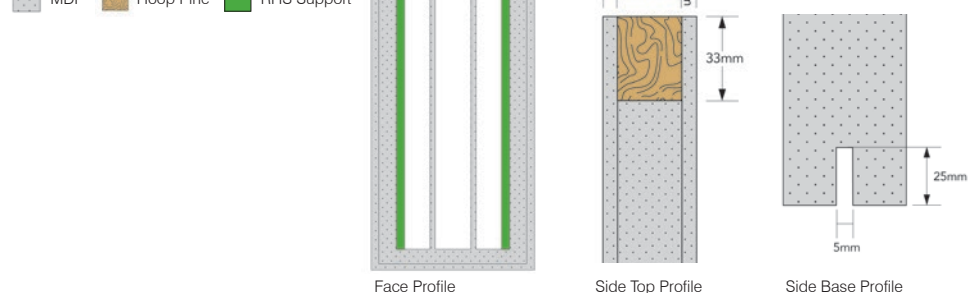

Code	Description	Sizes (mm)
MCXDFP	Metinno Door Semi-Solid MDF Flush Panel Pinetop With Groove & RHS Support	37 x 2700 x 720/820/920
		37 x 3000 x 720/820/920
		Custom sizes available - lead time applies



## Flush Panel Fire Rated Doors

A full range of 1 hour, 2 hour, 3 hour and 4 hour Fire Door sets, manufactured to your specifications and designed to cover all commercial and residential applications. All Fire Doors feature a monolithic refractory core, containing no asbestos or other inorganic fibres, with metal reinforcement to all hardware locations. A wide variety of finishes are available, including paint grade plywood, decorative timber veneers, pressed 4 or 6 panel, fire retardant plastic laminates, steel and stainless steel. All designs are certified & tested by the CSIRO and strictly conforms with AS1905. Part 1:2005.

### Construction Drawing

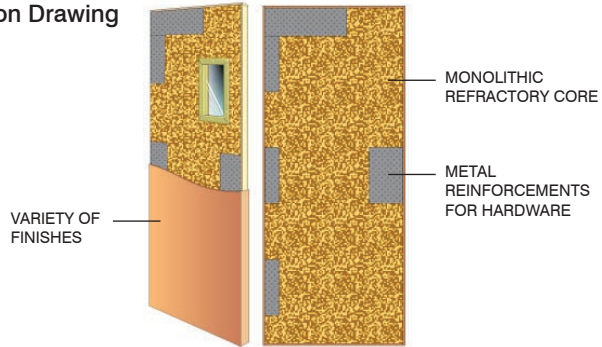

Description	Size	Fire Rating
Fire Rated Timber Door	Any custom sizes are available up to (H)3000 x (W)1800mm	1-4 hours

# Extras

## Finishes

Standard flush panel doors are also able to have a veneer finish. Enquire for samples and available grain cuts.



Rosewood



Sycamore



Hoop Pine



Spotted Gum



Sapelle Crown



American White Oak



European Beech



Tasmanian Oak



Blackwood



American Maple



Birch



Jarrah

## Meranti Timber Edgestrip

Exterior (tacked on) 12mm timber edgestrip for door edges. Available on 2 long edges or all 4 edges of door.

## Door Handing

### Single Door

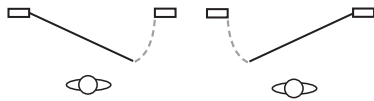

Left Hand

Right Hand

### Double Door

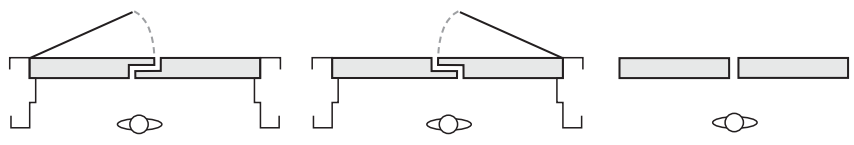

Left Hand Active Opening Away

Right Hand Active Opening Away

No Rebate

## Standard Viewing Panels\*

### Half Glazed

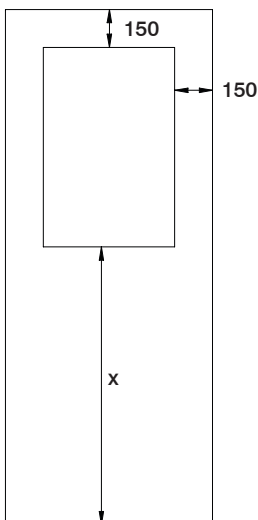

### Full Glazed

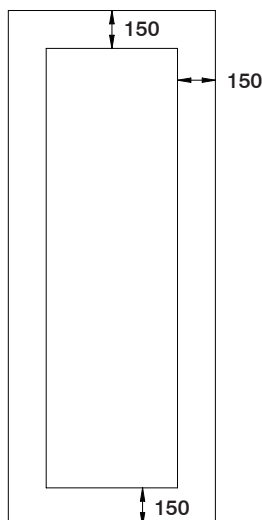

### Half Window Panel

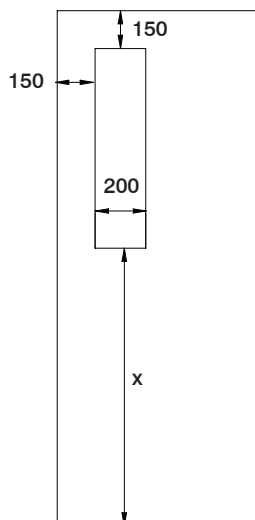

### Full Window Panel

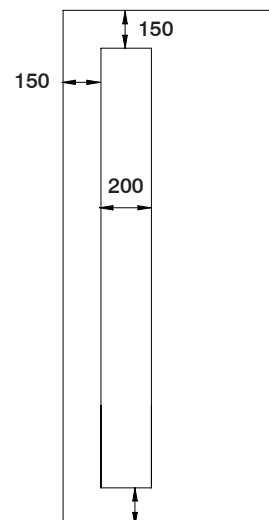

\*Custom sized viewing panels available on request.

## Care &amp; Treatment Guide

# Bowed Doors

**If your door has a bow in it, chances are that it has been:**

- Stacked on the floor unevenly
- Stored uncovered
- Stored with one side left/partially uncovered
- Stood against a wall for an extended period of time
- Kept in direct sunlight
- Kept in an environment high in moisture
- Left for too long without painting/sealing

**What to do if your door bows:****Raw doors:**

Place the door on a long edge, firmly propped upright in a stable environment with both sides of the door exposed. Use clean water and a clean cloth to dampen the inside of the bowed door. You want to change the colour of the MDF but not so it is saturated. Leave at least overnight, may take a day or two.

**Primed doors:**

Primed doors are a harder task. If the door has been stacked incorrectly/been leaning against a wall the best option you have to get it straight is to reverse the process - e.g. turn the door around and let it lean on the wall the other way, you should keep an eye on the door to check its progress. (Check between 8-12 hours).



**Raw: Lie on long edge, dampen the inside of bowed door.**

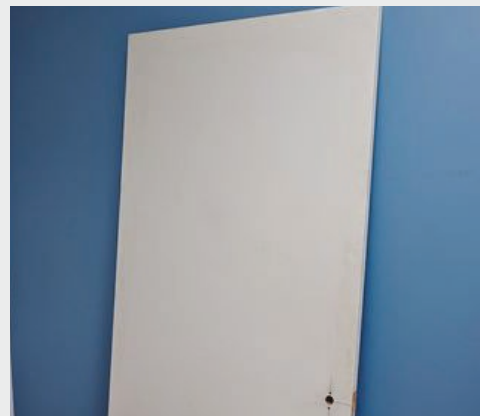

**Primed: Flip door to reverse the bow.**

For more information please contact our friendly team on (08) 8292 5000 or email [solutions@adxdepot.com.au](mailto:solutions@adxdepot.com.au)

## How to treat a door on-site

# Door Treatment

**For site trades receiving, storing & painting doors & frames on-site.**

### Transit Protection

All doors dispatched are securely packed on purpose made pallets to protect goods in transit and maintain the straightness of the doors.

### Delivery & Storage

When receiving the delivery, use the top packing sheet and 3 matched packers to store the doors flat on a level surface with a cover sheet over the top door. If the painters insist on leaning the doors against a wall to paint them, the base of the door must be no more than 150mm from base of wall for a 2100 door and 200mm for a 2400 door.

Place a 10mm packer between the centre of the top edge and the wall to prevent a twist or wind effect on the door. Rehang the doors as soon as finish is safe to handle.

### Sealing/Painting

Doors must be sealed on all 4 edges and both faces within 7 days of arriving to site with a sealer that will prevent the absorption/expulsion of moisture from the doors. Failure to carry this out will void the warranty immediately. Painter and/or paint manufacturer must warrant this sealer.

Immediately prior to hanging the door at least the bottom edge must receive a sealer coat (we recommend 2 coats of an oil based sealer) to prevent absorption and/or expulsion of moisture. Applying water based sealer, or worse, watering down water based paint and applying this to a door DOES NOT SEAL THE DOOR.

### Finish Coats

Immediately after the door has been hung, the entire door, including ALL EDGES must receive minimum two coats of paint, varnish or sealer to prevent absorption of moisture and/or shrinkage.

The objective of painting a door is to seal the timber, so that the absorption/expulsion of moisture is prevented. Your paint supplier should be consulted as to the number of coats required to effectively seal the door.

### Maintenance of Finish

It is the responsibility of the owner to maintain an ongoing adequate seal, according to the paint supplier's recommendations to prevent deterioration of the doors.



**Store on a flat surface & cover.**



**Seal all edges within 7 days.**



**Hung door needs 2 finish coats.**

For more information please contact our friendly team on (08) 8292 5000 or email [solutions@adxdepot.com.au](mailto:solutions@adxdepot.com.au)



**Doors & Door Hardware**

## **Timber Doors Selection Guide**

For more information & to buy online visit  
[www.adxdepot.com.au](http://www.adxdepot.com.au)



(08) 8292 5000 [solutions@adxdepot.com.au](mailto:solutions@adxdepot.com.au)