

Scyon™ Matrix™ cladding



What is it?

An exterior cladding system with a geometric, expressed-joint look.

Where do you use it?

In residential and medium-density applications wherever a modern design is required, including external walls in composite construction, upper-storey and ground-level extensions and internal feature walls.

What are the key benefits?

SIMPLE TO INSTALL. Instead of needing the steel top hats associated with many commercial systems, Scyon™ Matrix™ cladding sheets are installed with Scyon™ cavity trim battens. The expressed joint is created easily using a 10mm packer. Sheets are sanded smooth and pre-primed for fast paint application and a high-quality finish.

DESIGN OPTIONS. Square and rectangular panels with an expressed joint mean a variety of looks can be created, from horizontal and vertical stripes to geometric patterns. Sanded sheets give a flat, smooth finish and digital printing can add even more design options. Matrix™ cladding's resistance to cracking, warping and swelling* means it can be painted both dark and light colours. The option of brad nailing minimises visual interruption. Matrix™ cladding may be specified for timber-framed or steel-framed structures.

DURABILITY. The Matrix™ cladding panels are sealed on all sides for durability and stability.

ENHANCES ENERGY EFFICIENCY. When Matrix™ cladding is used with the right insulation and in accordance with the standard installation instructions, an R-Value of up to 3.3 can be achieved for the wall. Greater Total R-Values can be achieved through the use of cavity wall construction and reflective vapour permeable membranes. Refer to the James Hardie's Wall System Thermal Performance Total R-Values Technical Supplement for more information.

MADE FROM SCYON. Matrix™ cladding is made from Scyon™, the advanced lightweight cement composite with heavy-duty performance. Not only is it resistant to damage from termites, rot and fire*, but it can also be gun nailed and is easy to cut – like timber.

Matrix™ cladding installation

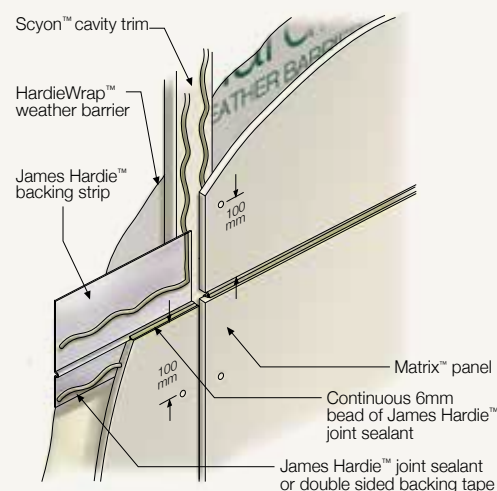

What are the sizes?

Product code	Length (mm)	Width (mm)	Thickness (mm)	Mass (kg/m ²)
403811	1,190	1,190	8	12.6
403810	2,390	590	8	12.6
403812	1,790	890	8	12.6
404169	2,990	1,190	8	12.6
Scyon™ cavity trim				
403840	2,450	70	19	3.4

What are the accessories?

Accessory	Code	Page
HardieBlade™ Saw Blade 185mm	300660	51
HardieBlade™ Saw Blade 254mm	303375	51
HardieDrive™ Screws 40mm long	305533	51
James Hardie™ 9mm Aluminium External Corner	305521	52
James Hardie™ Backing Strip 1,190mm	305557	53
James Hardie™ Backing Strip 2,390mm	305558	53
James Hardie™ Backing Strip 2,990mm	305559	53
James Hardie™ Base Coat 15kg Bag	304491	53
James Hardie™ Facade Washers	305565	53
James Hardie™ Joint Sealant* 300ml cartridge	305534	54
James Hardie™ Joint Sealant* 600ml sausage	305672	54
James Hardie™ 18mm PVC Cavity Vent Strip	305555	54

* When installed and maintained correctly and to the extent set out in James Hardie's published literature current at the time of installation.

^ Not to be used in fire applications.

MATRIX™

CLADDING

scyon™ Advanced
Cement Composite

A COMMERCIAL LOOK
WITHOUT THE PRICE TAG

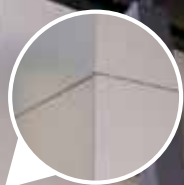

Scyon™ Matrix™
Cladding