

# PrimeLine® weatherboard

## What is it?

A pre-primed, site-painted weatherboard, available in a range of profiles from contemporary to traditional. The range includes the following weatherboards:

**PrimeLine® Summit.** A slender, beaded-edge weatherboard with a strong lap line. Compatible with the HardieLock™ fixing system.

**PrimeLine® Heritage.** A double-width weatherboard with rebated edges to create shadow lines.

**PrimeLine® Newport.** A smooth, narrow weatherboard. Compatible with the HardieLock™ fixing system.

**PrimeLine® Chamfer.** A double-width weatherboard with clean lines to create a shadow effect.

## Where do you use it?

As an external cladding in residential single and medium-density homes, including alterations and additions, where a traditional or contemporary weatherboard look is required. Ideal for full wrap or composite construction designs on either timber or light gauge steel framed homes.

## What are the key benefits?

**AFFORDABILITY.** PrimeLine weatherboards are pre-primed with a milled finish, making it easy to paint, and reducing the finishing time and cost.\*

**DESIGN FLEXIBILITY.** A wide variety of looks, from contemporary to traditional, can be achieved with the varying profiles in the range.

**FAST INSTALLATION.** Both the Summit and Newport profiles come with the HardieLock™ fixing system, which minimises the time needed to set out the boards. The PVC HardieLock spline that runs along the back of these profiles fits neatly over the lower board, locking it securely into position. Added to this, it enables off-stud joining, which minimises wastage and allows fasteners to be concealed, which enhances the finished look. Chamfer and Heritage profiles come in a double-width board, which allows faster wall coverage, and off-stud joining is possible with the PrimeLine® Universal Off Stud Joint Clip accessory\*.

**SECURITY.** PrimeLine weatherboard is resistant to damage from termites, rot and fire.\*\*



## What are the sizes?

Product code	Profile	Length (mm)	Width (mm)	Thickness (mm)	Mass (kg/m²)
400380	Summit <sup>Δ</sup>	4,200	230	9	13.24
400153	Heritage <sup>#</sup>	4,200	300	9	13.00
400319	Newport <sup>Δ</sup>	4,200	170	9	13.17
400103	Chamfer <sup>#</sup>	4,200	300	9	13.04

### Selling units per pack:

Summit: 120 lengths, Heritage: 90 lengths, Newport: 120 lengths, Chamfer: 90 lengths

## What are the accessories?

Accessory	Code	Page
HardieBlade™ Saw Blade 185mm	300660	51
HardieBlade™ Saw Blade 254mm	303375	51
HardieDrive™ Screws 32mm long	305532	51
HardieDrive™ Screws 40mm long	305533	51
James Hardie™ Aluminium Snap On Corner (2 pieces per set)	305513	53
James Hardie™ Fibreshears	300653	53
James Hardie™ Joint Sealant <sup>^</sup> 300ml cartridge	305534	54
James Hardie™ Joint Sealant <sup>^</sup> 600ml sausage	305672	54
James Hardie™ 7.5mm PVC Starter Strip	305568	55
James Hardie™ Score and Snap Knife	305576	55
PrimeLine® Galvanised Universal Off Stud Joint Clip <sup>+</sup>	305525	57

**Note** All dimensions and masses provided are approximate only and subject to manufacturing tolerances. Masses are based on equilibrium moisture content of product.

\* Always refer to the paint manufacturer's guidelines.

\*\* When installed and maintained correctly and to the extent set out in James Hardie's published literature current at the time of installation.

+ Not suitable for coastal applications, see installation manual for further information. <sup>Δ</sup> HardieLock® fixing system. <sup>#</sup> Double board profile. <sup>^</sup> Not to be used in fire applications.

### PrimeLine® Summit weatherboard

pre-primed board with slender beaded edge and strong lap line; HardieLock® fixing system.



### PrimeLine® Heritage weatherboard

pre-primed double board width, with rebated edge to create shadow lines.



### PrimeLine® Newport weatherboard

pre-primed smooth, narrow board; HardieLock® fixing system.



### PrimeLine® Chamfer weatherboard

pre-primed double board width, with clean lines to create shadow effect.



Installing first PrimeLine® Summit or Newport weatherboard

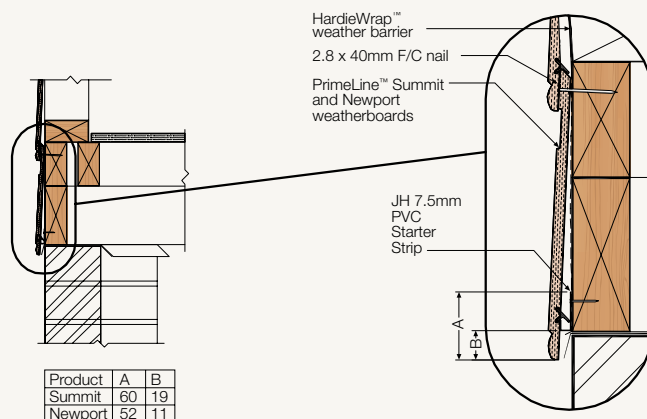

Internal corner†

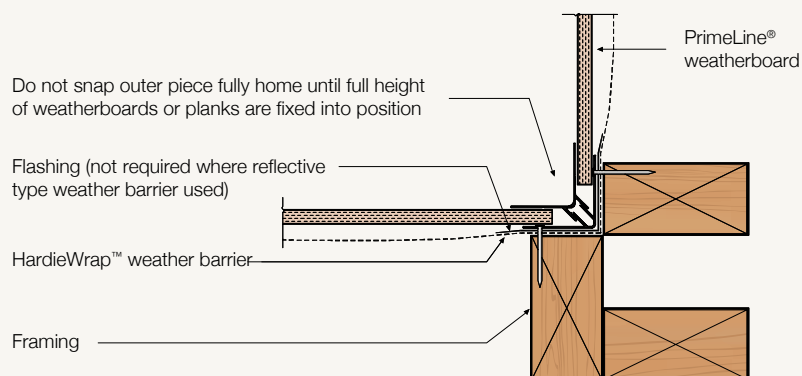

†Note: Use pliers to break off teeth along score line and fix.