

ExoTec® facade panel and fixing system



What is it?

A fully sealed, compressed facade panel installed with a proprietary fixing system. Features expressed joints and is either site-painted or pre-finished off-site. ExoTec facade panel is the most popular fibre cement commercial facade system.

Where do you use it?

As an external facade, fascia or soffit on commercial buildings requiring a durable, low-maintenance and impact-resistant system, and an expressed-jointed panel look. It's suitable for either full wrap panel or composite designs.

What are the key benefits?

DESIGN FLEXIBILITY. A variety of panel patterns can be achieved, including vertical, horizontal and staggered – fixed with a choice of either countersunk concealed fasteners or exposed screw heads. To add to this, a wide range of decorative paint finishes can be used, including site-applied acrylic textures and factory-applied polyurethane plain and metallic colours.

EASY SPECIFICATION. The designer and installer do not need to make allowances for panel expansion or contraction resulting from weather change, because the compressed panel is sealed on all sides, making it very stable, and the design of the proprietary fixing system helps to absorb any building movement.

DURABILITY. The compressed panel structure delivers high levels of impact resistance, making it a smart choice for commercial areas that are prone to wear and tear.

FAST INSTALLATION. The reliable proprietary fixing system makes commercial installations fast, easy and cost-effective.

MOISTURE RESISTANCE. The compressed panels are sealed on all six sides to improve moisture resistance. Added to this, the proprietary ExoTec® Gasket Snap Strip provides an initial weather seal which further improves moisture management and building soundness.

SECURITY. ExoTec facade panel is resistant to damage from termites, rot and fire.*



What are the sizes?

Product code	Length (mm)	Width (mm)	Thickness (mm)	Mass (kg/m²)
402200	1,800	900	9	16.26
402201	1,800	1,200	9	16.26
402203	2,100	1,200	9	16.26
402204	2,400	900	9	16.26
402205	2,400	1,200	9	16.26
402333	2,400	1,200	12	21.90
402207	2,700	1,200	9	16.26
402208	3,000	900	9	16.26
402209	3,000	1,200	9	16.26
402334	3,000	1,200	12	21.90

Selling units per pack: 9mm – 16 sheets or each, 12mm – 12 sheets or each

What are the accessories?

Accessory	Code	Page
ExoTec® Gasket Snap Strip	305556	50
ExoTec® Top Hat 6,000mm	304572	50
ExoTec® Top Hat 7,200mm	304571	50
HardieBlade™ Saw Blade 185mm	300660	51
HardieBlade™ Saw Blade 254mm	303375	51
James Hardie™ Backing Strip 1,190mm	305557	53
James Hardie™ Backing Strip 2,390mm	305558	53
James Hardie™ Backing Strip 2,990mm	305559	53
James Hardie™ Facade Washers	305565	53
James Hardie™ Intermediate Top Hat 6,000mm	302701	54
James Hardie™ Intermediate Top Hat 7,200mm	302700	54
James Hardie™ Joint Sealant* 300ml cartridge	305534	54
James Hardie™ Joint Sealant* 600ml sausage	305672	54

Top hat and panel fixing detail

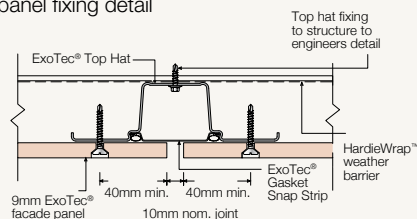

Note All dimensions and masses provided are approximate only and subject to manufacturing tolerances. Masses are based on equilibrium moisture content of product.
 * When installed and maintained correctly and to the extent set out in James Hardie's published literature current at the time of installation. ^ Not to be used in fire applications.